



**CERTIFIED EQUITY
PROFESSIONAL INSTITUTE
SILICON VALLEY EXECUTIVE CENTER**

**20th Annual CEPI and Silicon Valley
NASPP Symposium**

**July 23, 2024
Santa Clara University**



Certified Equity Professional Institute (CEPI)

The CEPI is the *only* academic non-profit focused on equity compensation. Offering certification, research, and continuing education, the CEPI is well positioned in the equity compensation industry and has a proven track record of meeting and exceeding the needs of today's equity compensation professionals.



20th Annual CEPI and SV NASPP Symposium

Geared for Success

- **Format**

- In-person on the SCU campus, attendance limit 300
- Recorded sessions available post-event

- **Content**

- Four sessions, each with five separate presentations (20 total available), carefully selected to ensure relevant, usable content; attendees can apply content immediately in their job functions.

- **Location**

- One-day event in the Leavey School of Business Lucas Hall, with high-quality content and extensive networking opportunities.



Exhibitor Space

1st Floor

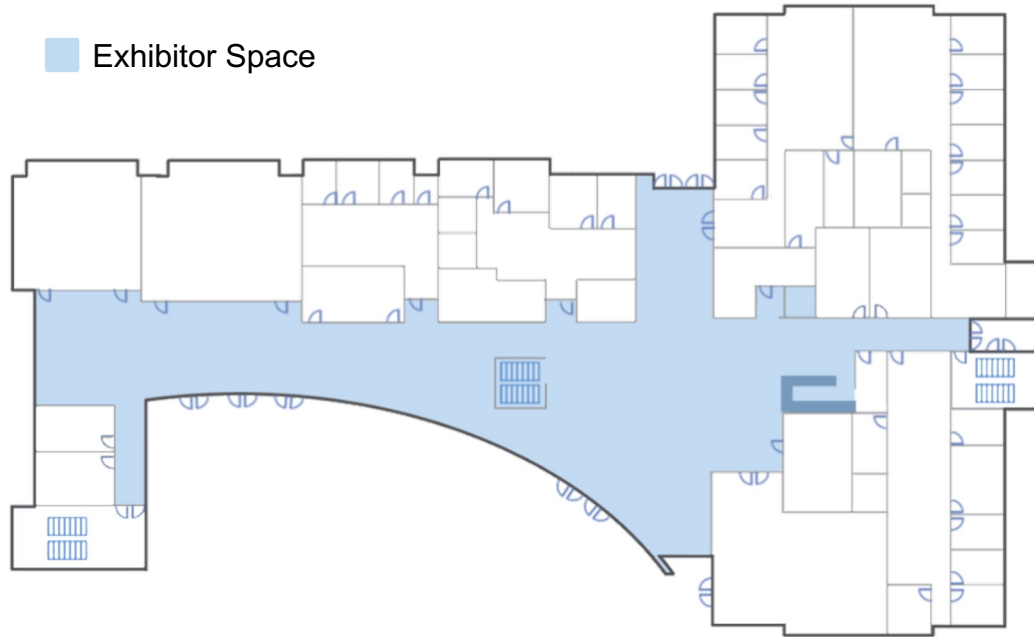



2024 Symposium Packages – Pavilion Level

- **Pavilion Level**
 - Featured sponsors
 - Attendee registration list provided for one-time email contact use
- **Symposium Passes**
 - 10 Symposium passes included for client attendees
 - 3 Symposium limited access passes included for sponsor use (exhibitor only)
- **Recognition**
 - Recognized in Symposium communications and on CEPI website
 - 8' exhibitor table
 - Large logo on sponsor page
- **Option to add a private event before or after the Symposium**



2024 Symposium Packages – Exhibitor Level

- **Exhibitor Level**

- Popular option
- Attendee registration list provided for one-time email contact use

- **Symposium Passes**

- 5 Symposium passes for client attendees
- 2 Symposium limited access passes included for sponsor use (exhibitor only)

- **Recognition**

- Recognized in Symposium communications on CEPI website
- 8' exhibitor table
- Medium logo on sponsor page



2024 Symposium Packages – Supporter Level

- **Supporter Level**
 - Economical way to support event
- **Symposium Passes**
 - 2 Symposium limited access passes included for sponsor use (exhibitor only)
- **Recognition**
 - Recognized in Symposium communications and on CEPI website
 - Small logo on sponsor page



2024 Symposium Sponsorships

Commitment due by May 15, 2024

Sponsorship	*Pavilion: \$7,000	Exhibitor: \$3,500	Supporter: \$1,000
Logo on Sponsorship Page	Large	Medium	Small
8 Foot Exhibitor Table?	Yes	Yes	No
Client Attendee Passes	10	5	0
Exhibitor Passes	3	2	2
\$50 Off Additional Client Passes?	Yes	Yes	Yes

*Pavilion Level Sponsor tables are situated in the most desirable location near the entrance and reg./info table.



Contact

CEPI Team

cepi@scu.edu

www.scu.edu/business/cepi